

SANG-A ST Serisi Plastik Susturucular

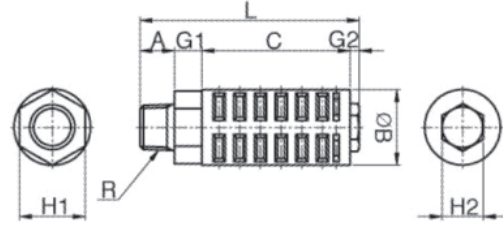

Boyutlar

MODEL [ØD-T] Tube: (Metric) - Thread: (R)

(mm)

MODEL	R	ØB	L	C	A	H1	H2	G1	G2	W.G(g)	Q'ty/ inbox
ST M5	M5	7.5	18	-	5	-	-	-	-	0.5	100
ST 01	R $\frac{1}{8}$	10.6	36.1	25.7	8	-	5.5	-	2.4	3	100
ST 02	R $\frac{1}{4}$	22	63.7	43	10	19	12	8	2.7	10.5	25
ST 03	R $\frac{3}{8}$	25	84.5	58	13.5	22	14	10	3.0	18.5	20
ST 04	R $\frac{1}{2}$	30	93.5	64	15.5	27	19	10.5	3.5	29.5	12
ST G01	R $\frac{1}{8}$	16	41	25	7	14	8	7	2	4.5	50
ST G02	R $\frac{1}{4}$	21	64	42.5	10	18	12	10	2.5	12	25
ST G03	R $\frac{3}{8}$	25	85	59.5	13	21.5	14.5	10	2.5	19.5	20
ST G04	R $\frac{1}{2}$	30	94	67	14	26	19	10	3	30	12

* The color of ST M5, ST G is gray.

- **Application** : Used for suppressing the noise of air release, applied to exhausted port of machine.

- **Material** : PBT,PE

- **Feature** : Small size used for in low noisy applications.

Made of plastic, very light and strong.

Compact design is suitable for installing in confined space.