

## Speed Controls

### WSS-G SERIES



#### Product features

Used to control the speed of the working equipment  
Because of the resin body and metal body rotation lead to the direction is free

#### Speciality

Fluid	Air /no other gases or liquids)
Operating Pressure	0.1~1 MPa ( 15~150psi )
Max Pressure	-1.8 MPa
Operating Temperature	-60°C (32-140°F)
Applicable Tube	PU Polyurethane and Nylon

#### Ordering Code

<b>W</b>	<b>PC</b>	<b>8</b>	<b>-</b>	<b>01</b>	<b>-</b>	<b>*</b>
<b>(1)</b>	<b>(2)</b>	<b>(3)</b>	<b>(4)</b>	<b>(4)</b>	<b>(4)</b>	<b>(5)</b>

#### Metric Size

Code	4	5	6	7	8	9	10	11	12	13	14	15	16
Tube Outer Diameter mm	φ4	φ5	φ6	φ7	φ8	φ9	φ10	φ11	φ12	φ13	φ14	φ15	φ16

#### Inch Size

Code	5/32	3/16	1/4	5/16	3/8	1/2
Tube Outer Diameter mm	φ5/32	φ3/16	φ1/4	φ5/16	φ3/8	φ1/2

#### (4) Thread type and size

#### Metric Size

Code	M5	M6	M8	M10	M12	M12A	M14	M16	M20
Thread	M5*0.8	M6*1	M8*1	M10*1	M12*1.25	M12*1.5	M14*1.5	M16*1.5	M20*1.5

#### 55° Taper Pipe Thread (NPT)

Code	01	02	03	04	06
Thread	R1/8	R1/4	R3/8	R1/2	R3/4

#### 55° Taper Pipe Thread (NPT)

Code	G01	G02	G03	G04	G06
Thread	G1/8	G1/4	G3/8	G1/2	G3/4

#### UNF

#### 60° American Standard Taper Pipe Thread (NPT)

Code	U10	NO1	NO2	NO3	NO4	NO6
Thread	10-32UNF	NPT1/8	NPT1/8	NPT1/4	NPT1/2	NPT3/4

Note: The external dimension of fitting size is connected the outer diameter odd no. ( φ5, φ7, φ9, φ11, φ13) will be suit φ6, φ10, φ12, φ14

Speed Controls

WSS-G SERIES

Dimensions

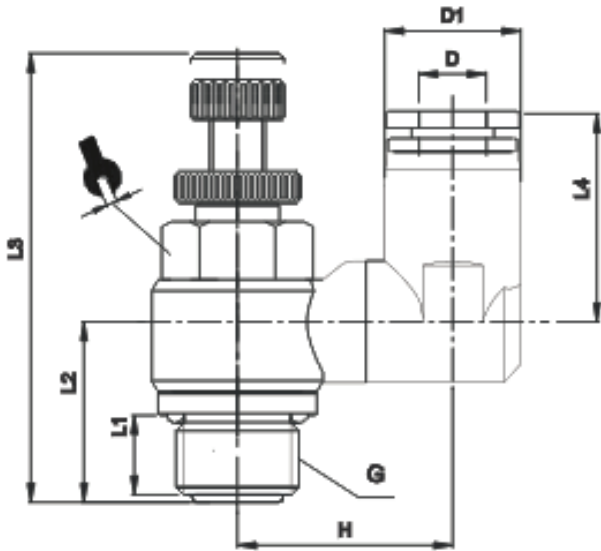

MODEL	$\phi D$	G	L1	L2	L3	L4	$\phi D1$	
WSS04-G01(B)	4	G1/8	5.5	14	42	26.5	15	12
WSS04-G02(B)	4	G1/4	7.5	17.5	48	27	15	14
WSS06-G01(B)	6	G1/8	5.5	14	42	26.5	15	12
WSS06-G02(B)	6	G1/4	7.5	17.5	48	27	15	14
WSS08-G01(B)	8	G1/8	5.5	17.5	42	26.5	15	12
WSS08-G02(B)	8	G1/4	7.5	21.5	48	27	15	14
WSS10-G02(B)	10	G1/4	7.5	17.5	48	30	21.5	14
WSS10-G03(B)	10	G3/8	7.5	21.5	53	31	21.5	19
WSS12-G02B)	12	G1/4	7.5	17.5	48	30	21.5	14
WSS12-G03B)	12	G3/8	7.5	21.5	53	31	21.5	19