

## Speed Controls

### WSCA-G SERIES



#### Product features

Used to control the speed of the working equipment  
Because of the resin body and metal body rotation lead to the direction is free

#### Speciality

Fluid	Air /no other gases or liquids)
Operating Pressure	0.1~1 MPa ( 15~150psi )
Max Pressure	-1.8 MPa
Operating Temperature	-60 C (32-140 F)
Applicable Tube	PU Polyurethane and Nylon

#### Ordering Code

<b>W</b>	<b>PC</b>	<b>8</b>	<b>-</b>	<b>01</b>	<b>-</b>	<b>*</b>
<b>(1)</b>	<b>(2)</b>	<b>(3)</b>	<b>(4)</b>	<b>(5)</b>		

#### Metric Size

Code	4	5	6	7	8	9	10	11	12	13	14	15	16
Tube Outer Diameter mm	φ4	φ5	φ6	φ7	φ8	φ9	φ10	φ11	φ12	φ13	φ14	φ15	φ16

#### Inch Size

Code	5/32	3/16	1/4	5/16	3/8	1/2
Tube Outer Diameter mm	φ5/32	φ3/16	φ1/4	φ5/16	φ3/8	φ1/2

#### (4) Thread type and size

#### Metric Size

Code	M5	M6	M8	M10	M12	M12A	M14	M16	M20
Thread	M5*0.8	M6*1	M8*1	M10*1	M12*1.25	M12*1.5	M14*1.5	M16*1.5	M20*1.5

#### 55° Taper Pipe Thread (NPT)

Code	01	02	03	04	06
Thread	R1/8	R1/4	R3/8	R1/2	R3/4

#### 55° Taper Pipe Thread (NPT)

Code	G01	G02	G03	G04	G06
Thread	G1/8	G1/4	G3/8	G1/2	G3/4

#### UNF

#### 60° American Standard Taper Pipe Thread (NPT)

Code	U10	NO1	NO2	NO3	NO4	NO6
Thread	10-32UNF	NPT1/8	NPT1/8	NPT1/4	NPT1/2	NPT3/4

Note: The external dimension of fitting size is connected the outer diameter odd no. ( φ5, φ7, φ9, φ11, φ13) will be suit φ6, φ10, φ12, φ14

## Speed Controls

### WSCA-G SERIES

#### Dimensions

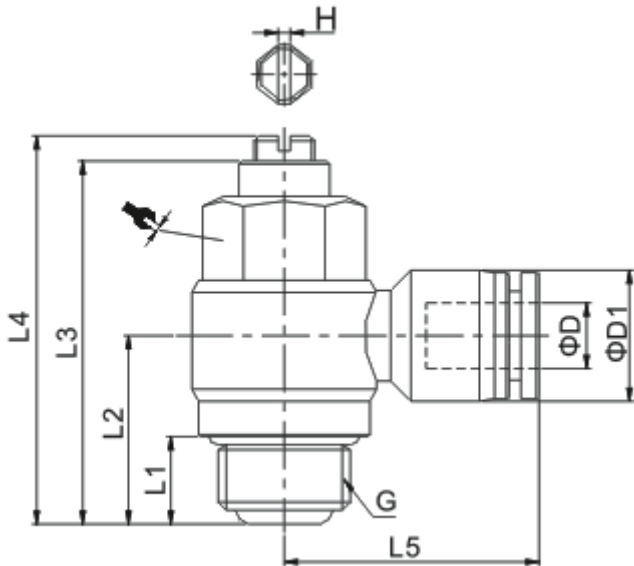

MODEL	$\phi D$	G	L1	L2	L3	L4	L5	$\phi D1$	H	
WSCA04-G01(B)	4	G1/8	6	15	29	32	23	11.3	0.8	12
WSCA04-G02(B)	4	G1/4	8.5	18.5	34.8	37.5	25.2	11.3	1.2	14
WSCA06-G01(B)	6	G1/8	6	15	29	32	23	13.3	0.8	12
WSCA06-G02(B)	6	G1/4	8.5	18.5	34.8	37.5	25	13.3	1.2	14
WSCA06-G03(B)	6	G3/8	10	22	40.8	43.5	26.7	13.3	1.2	19
WSCA06-G04(B)	6	G1/2	12	26	46.6	51	32	13.3	1.6	24
WSCA08-G01(B)	8	G1/8	6	15.8	29	32	25.8	15	0.8	12
WSCA08-G02(B)	8	G1/4	8.5	19.5	34.8	37.5	28.9	15	1.2	14
WSCA08-G03(B)	8	G3/8	10	21.3	40.8	43.5	29.8	15	1.2	19
WSCA08-G04(B)	8	G1/2	12	26	46.6	51	32.8	15	1.6	24
WSCA10-G01(B)	10	G1/8	6	17.5	29	32	30.3	19	0.8	12
WSCA10-G02(B)	10	G1/4	8.5	21.2	34.8	37.5	32.7	19	1.2	14
WSCA10-G03(B)	10	G3/8	10	23.2	40.8	43.5	33	19	1.2	19
WSCA10-G04(B)	10	G1/2	12	26.2	46.6	51	36	19	1.6	24
WSCA12-G02(B)	12	G1/4	8.5	22.5	34.8	37.5	33.5	21.5	1.2	14
WSCA12-G03(B)	12	G3/8	10	24.5	40.8	43.5	33.5	21.5	1.2	19
WSCA12-G04(B)	12	G1/2	12	27.5	46.6	51	33.5	21.5	1.6	24