

Push-in Fittings

WPMT SERIES



Product features

- It's made of copper pneumatic piping joints
- Not only the body but also the sleeve, both of them are made from copper, which is good for flame resistance, heat resistance and splash performance

Speciality

Operating Temperature	-20~+80°C
Operating Pressure	0-1.0MPa
Fluid	Aia, Vacuum
Applicable Tube	Polyurethane and Nylon

Dimension

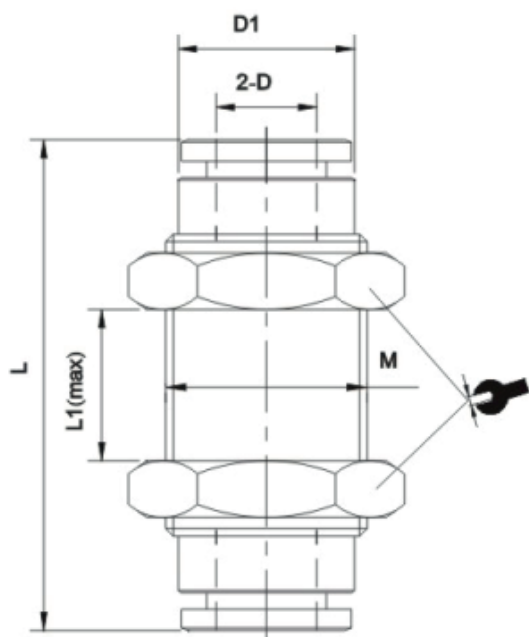

MODEL	ϕD	$\phi D1$	L	L1(max)	M	
WPMT 04	4	8.5	30.3	8	M10X1	14
WPMT 06	6	12	39	13	M14X1	17
WPMT 08	8	14	41.4	14	M16X1	19
WPMT 10	10	16	45.3	13	M18X1	21
WPMT 12	12	18	49	18	M20X1	24