

## Push-in Fittings

### WPLT-G SERIES



#### Product features

- It's made of copper pneumatic piping joints
- Not only the body but also the sleeve, both of them are made from copper, which is good for flame resistance, heat resistance and splash performance

#### Speciality

Operating Temperature	-20~+80°C
Operating Pressure	0-1.0MPa
Fluid	Aia, Vacuum
Applicable Tube	Polyurethane and Nylon

#### Dimension

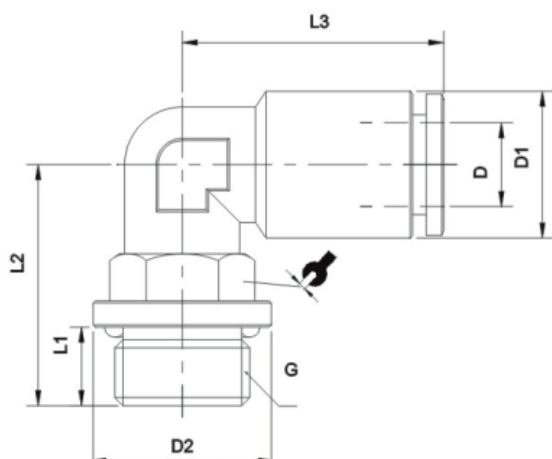

MODEL	$\phi D$	G	L1	L2	L3	$\phi D1$	$\phi D2$	
WPLT04-G01	4	G1/8	5.5	18.5	18.5	8.5	14	14
WPLT04-G02	4	G1/4	7.5	22.5	18.5	8.5	17	10
WPLT06-G01	6	G1/8	5.5	18.5	23.5	12	14	14
WPLT06-G02	6	G1/4	7.5	22.5	23.5	12	17	10
WPLT06-G03	6	G3/8	7.5	23.5	23.5	12	20	10
WPLT06-G04	6	G1/2	10	26	23.5	12	24	10
WPLT08-G01	8	G1/8	5.5	19.5	25.7	14	14	14
WPLT08-G02	8	G1/4	7.5	23.5	25.7	14	17	12
WPLT08-G03	8	G3/8	7.5	24	25.7	14	20	12
WPLT08-G04	8	G1/2	10	26.5	25.7	14	24	12
WPLT10-G01	10	G1/8	5.5	21.5	29	16	14	12
WPCFT10-G02	10	G1/4	7.5	25.5	29	16	17	14
WPCFT10-G03	10	G3/8	7.5	25.5	29	16	20	14
WPCFT10-G04	10	G1/2	10	28.5	29	16	24	14
WPCFT12-G02	12	G1/4	7.5	25	30.7	18	17	17
WPCFT12-G03	12	G3/8	7.5	26.5	30.7	18	20	17
WPCFT12-G04	12	G1/2	10	29	30.7	18	24	17