

Ordering Code

WMOS - TB - 040 - - - - -

- 1
Model
- 2
Drive Unit
- 3
Size
- 4
Stroke
- 5
Lead
- 6
Driving Side
- 7
Mounting Kit Model
- 8
Mounting Kit Assembly

1 - Model

WMOS: Belt Driven Linear Module

2 - Drive Unite

TB: Timing Belt

3 - Size

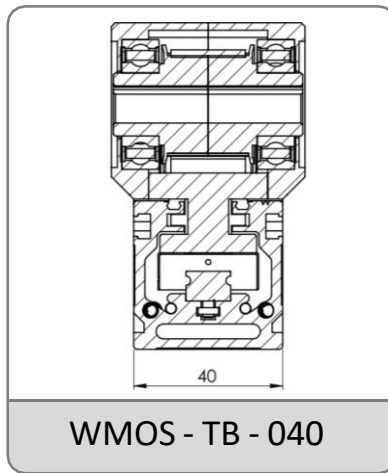

4 - Stroke

0000: Maximum 2685 mm

Movement Stroke

In addition to the desired movement stroke, it is recommended to leave a space on both sides until Ss.

$$S_m = S_e + 2 \cdot S_s$$

$$S_s = 50 \text{ mm}$$

S_m : Movement Stroke
 S_e : Safety Stroke

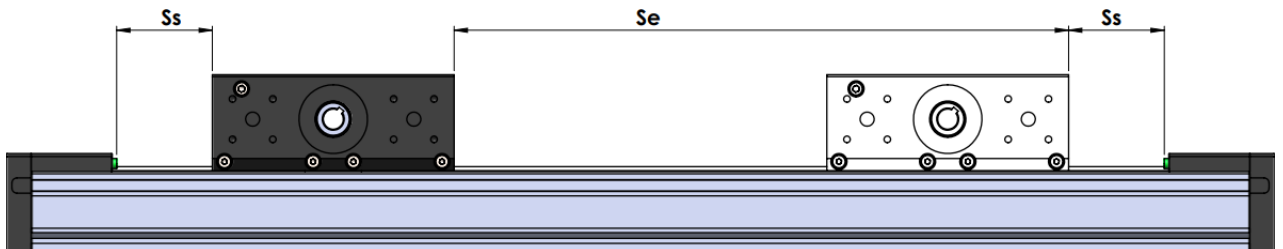

5 - Lead

90 : 90 mm/rev

Ordering Code

WMOS - TB - 040 - - - - - -

- | | | | | | | | |
|-------|------------|------|--------|------|--------------|--------------------|-----------------------|
| 1 | 2 | 3 | 4 | 5 | 6 | 7 | 8 |
| Model | Drive Unit | Size | Stroke | Lead | Driving Side | Mounting Kit Model | Mounting Kit Assembly |

6 - Ordering Code

<p style="background-color: #e0e0e0; padding: 2px; margin-bottom: 5px;">00 - Standard</p>	<p style="background-color: #e0e0e0; padding: 2px; margin-bottom: 5px;">01</p>	<p style="background-color: #e0e0e0; padding: 2px; margin-bottom: 5px;">02</p>
--	---	---

7 - Mounting Kit Model

00 :Without Mounting (STANDARD)	01 : WDAK Axial Kit

Note 1 : Please contact for different motor types and mounting sizes.

Note 2 : Please contact for to use gearbox.

8 - Mounting Kit Assembly

<p>00 :Without Motor (Standard)</p>	<p>070 :ø70 reducer mounting</p>
--	---

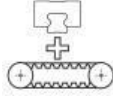
WINMAN WMOS-040 Series Omega Belt Driven Linear Modules

Specification		Mounting by the Drive Block	Mounting by the Profile	
Maximum Stroke [mm]		880	2685	
Minimum Stroke [mm]			60	
Repeating Accuracy [mm]			< 0,1	
Speed [m/s]			≤ 5,0	
Acceleration [m/s ²]			50	
Dynamic Load Capacity [Nm]		Dynamic Torsional Moment Load Capacity [Nm]		
C		M_t	M_L	
5266		31	118	
Maximum Permissible Torsional Moment Around The Axis [Nm]			Maximum Dynamic Load in Directions [Nm]	
M_x max	M_y max	M_z max	F_y max	F_z max
15	39	61	2650	1725

Note : Calculated value are theoretical values. We recommend you to calculate safety factor as five (5).

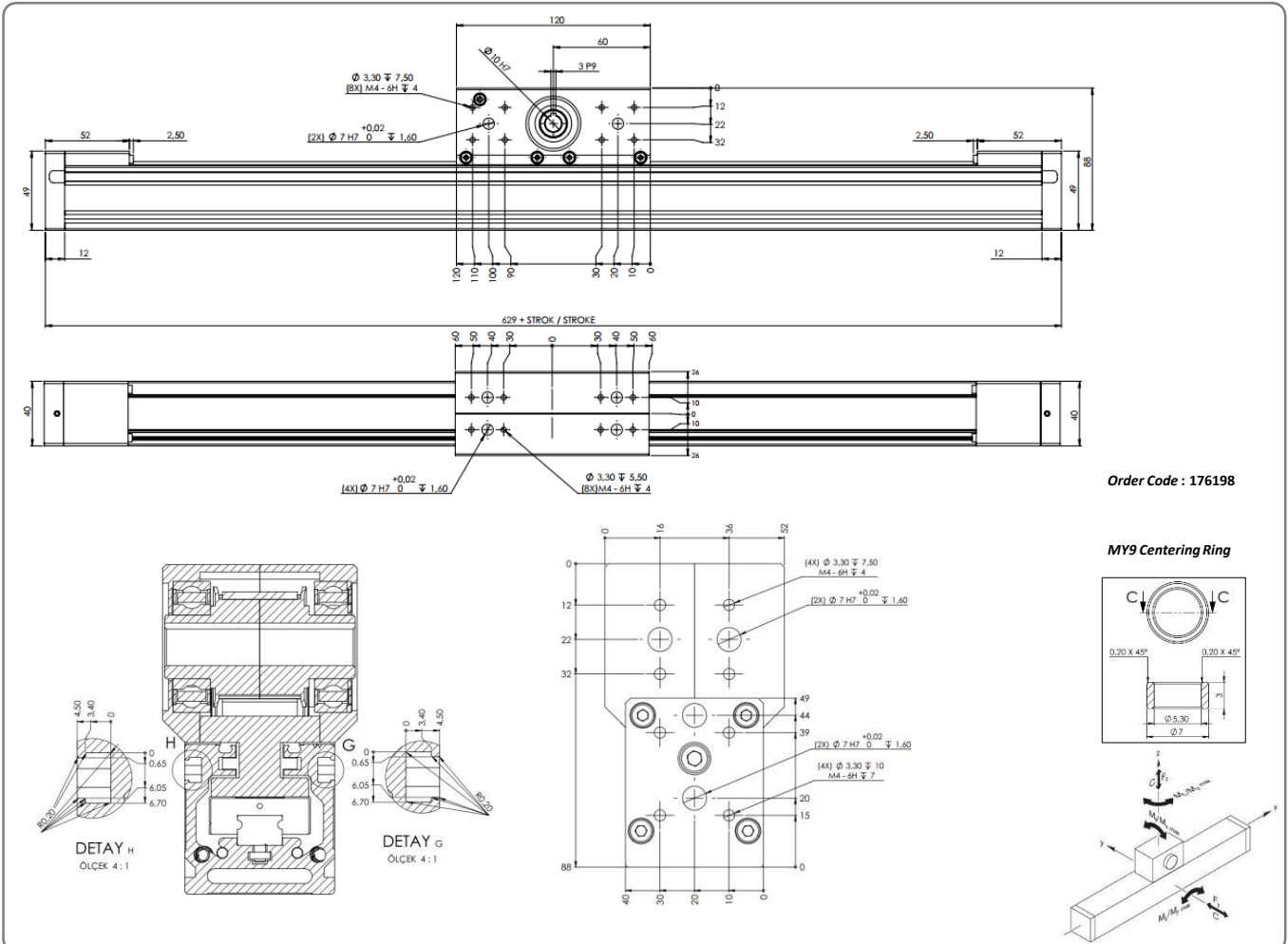
Technical Drawing

Order Code : 176198

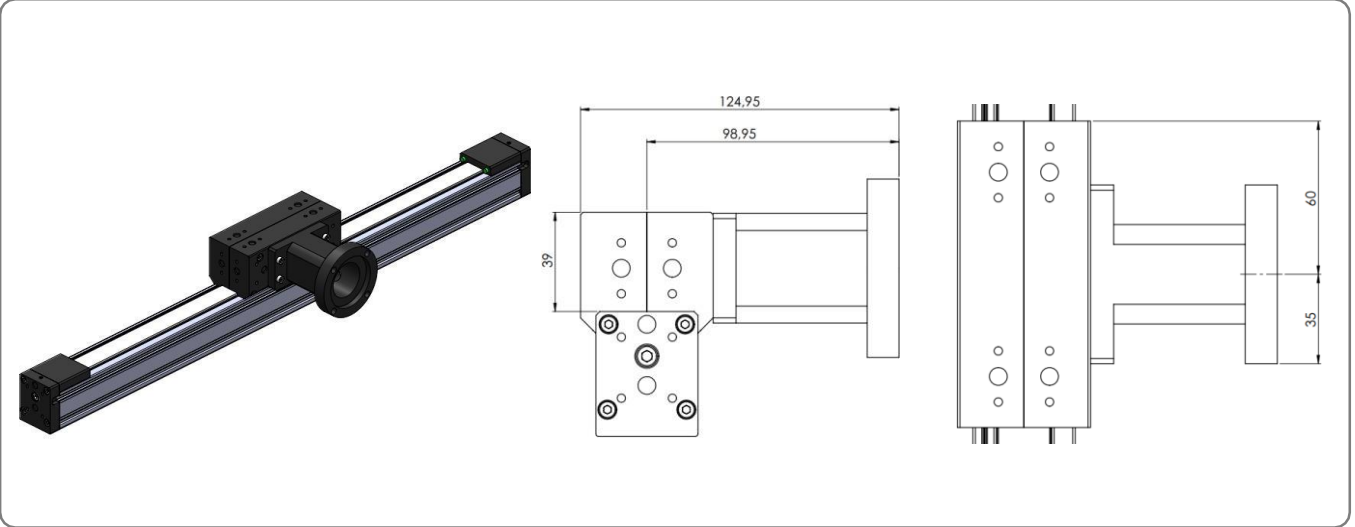
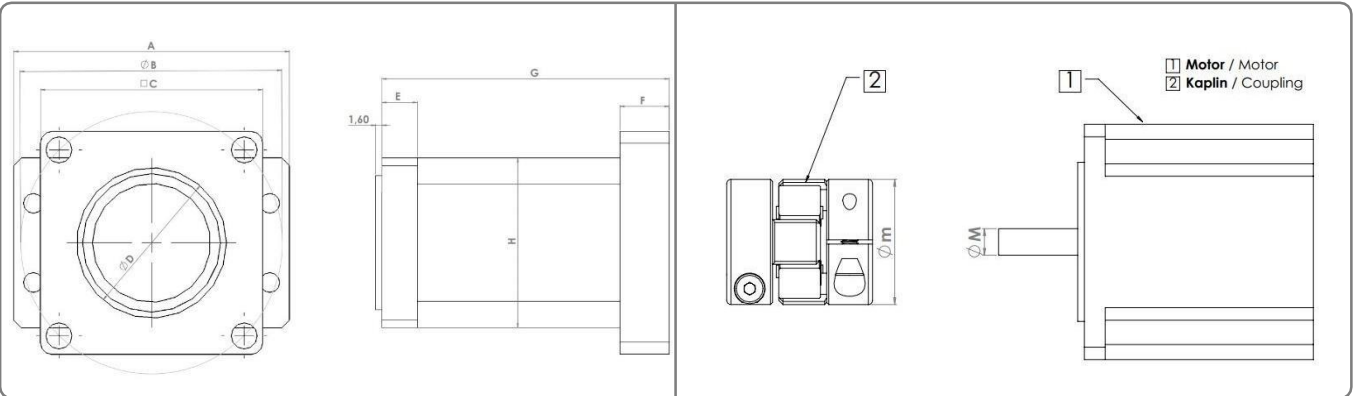
WDAK Axial Mounting Kit
Technical Drawing

Bellhousing - Coupling
Motor Mounting

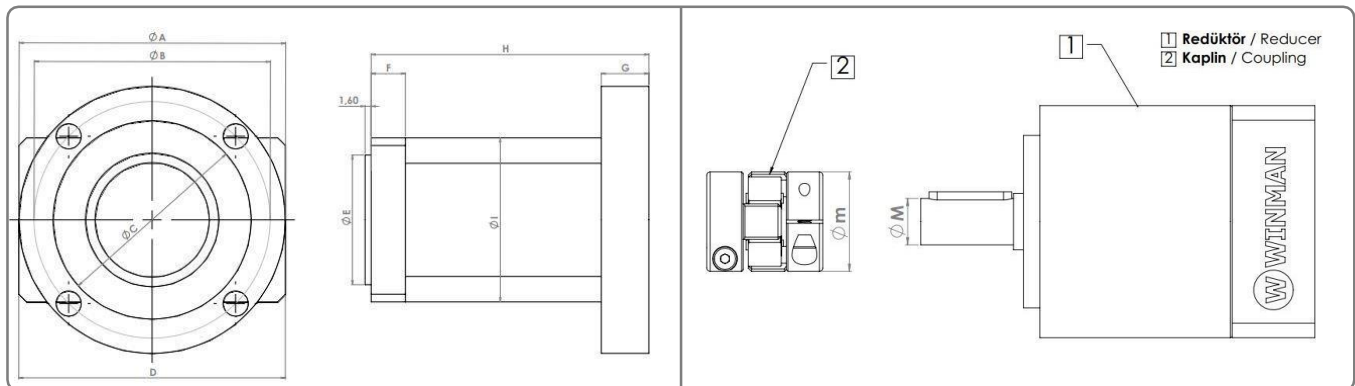
Motor Type	A	B	C	D	E	F	G	H	Motor Type	M	m	Coupling Model
WDAK - 070	70	66	57	38	9	12,5	73	43	WDAK - 070	19	40	WWJC - 30CRD

Reducer Mounting

Motor Type	A	B	C	D	E	F	G	H	I	Motor Type	M	m	Coupling Model
WDAK - 070	70	62	52	70	34	9	12,5	73	43	WDAK - 070	14	30	WWJC - 30CRD

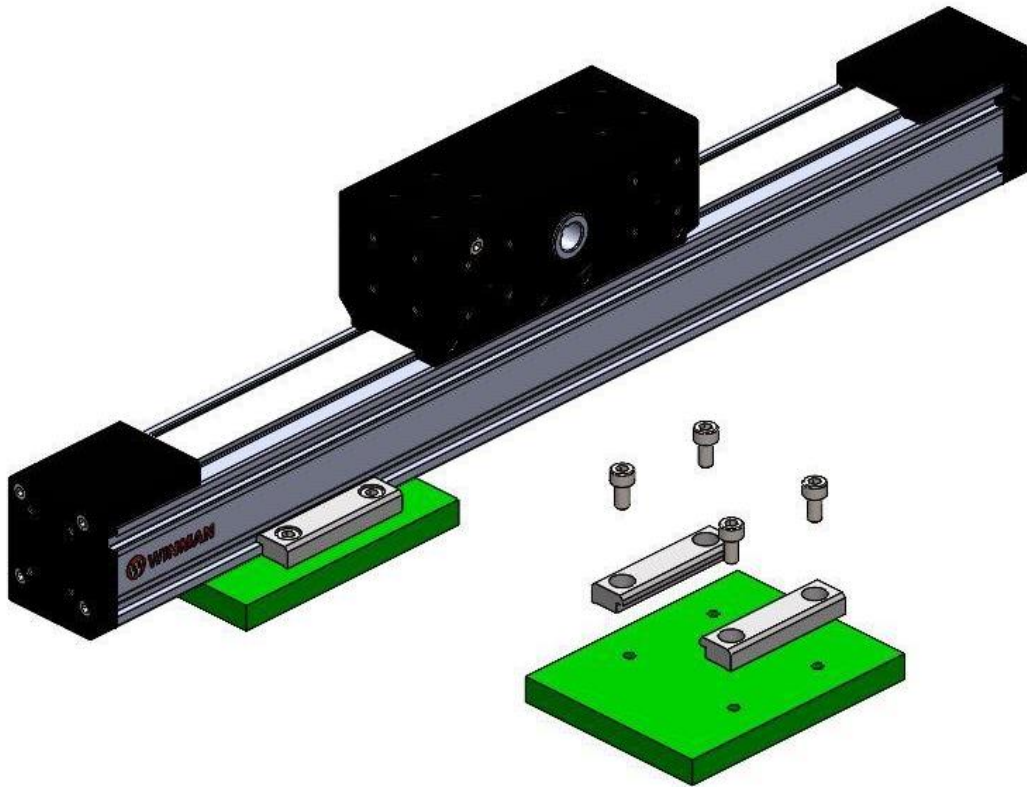
Assembly



Order Code : 176194

Mounting Bracket

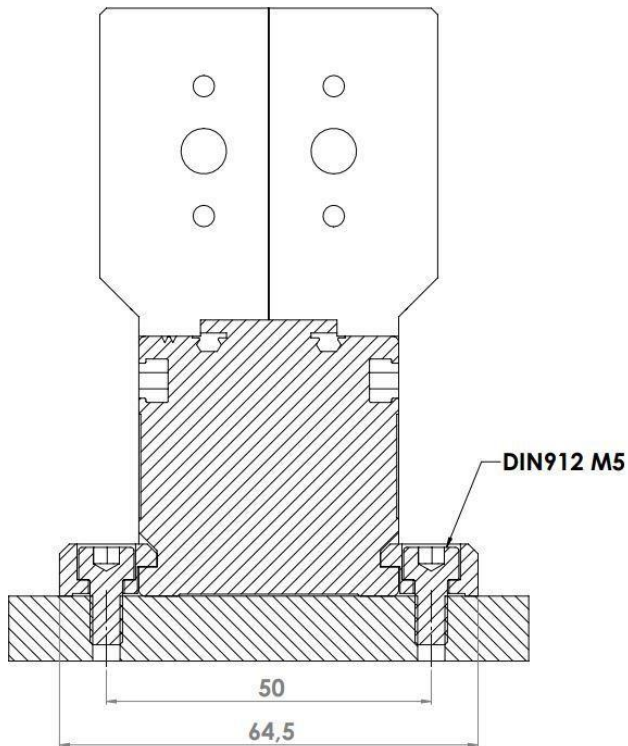

**WMOS 040
Clamping Fixtures**

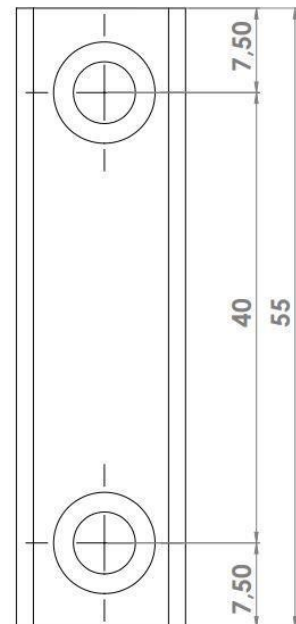

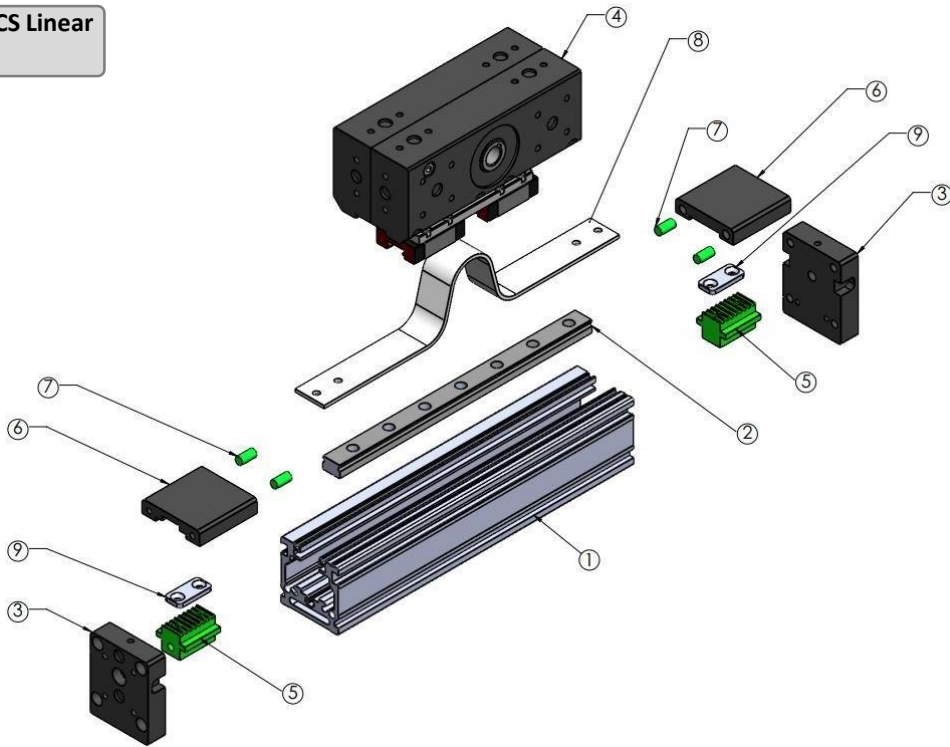
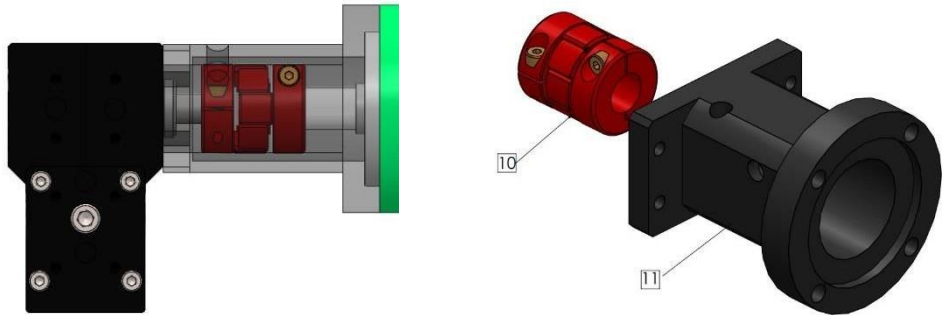
Assembly
WMOS / WMCS Linear Module

WDAK Axial Kit

Piece	Qty	Part Name	Assembly
1	1	Profile	Module
2	1	Ball Screw	
3	2	Block	
4	1	Mounting Plate	
5	2	Belt Mounting Parts	
6	2	Block Part	
7	4	Block Holder	
8	1	Belt	
9	2	Belt Mounting Parts	
10	1	Coupling	Axial Kit
11	1	Bell Housing	

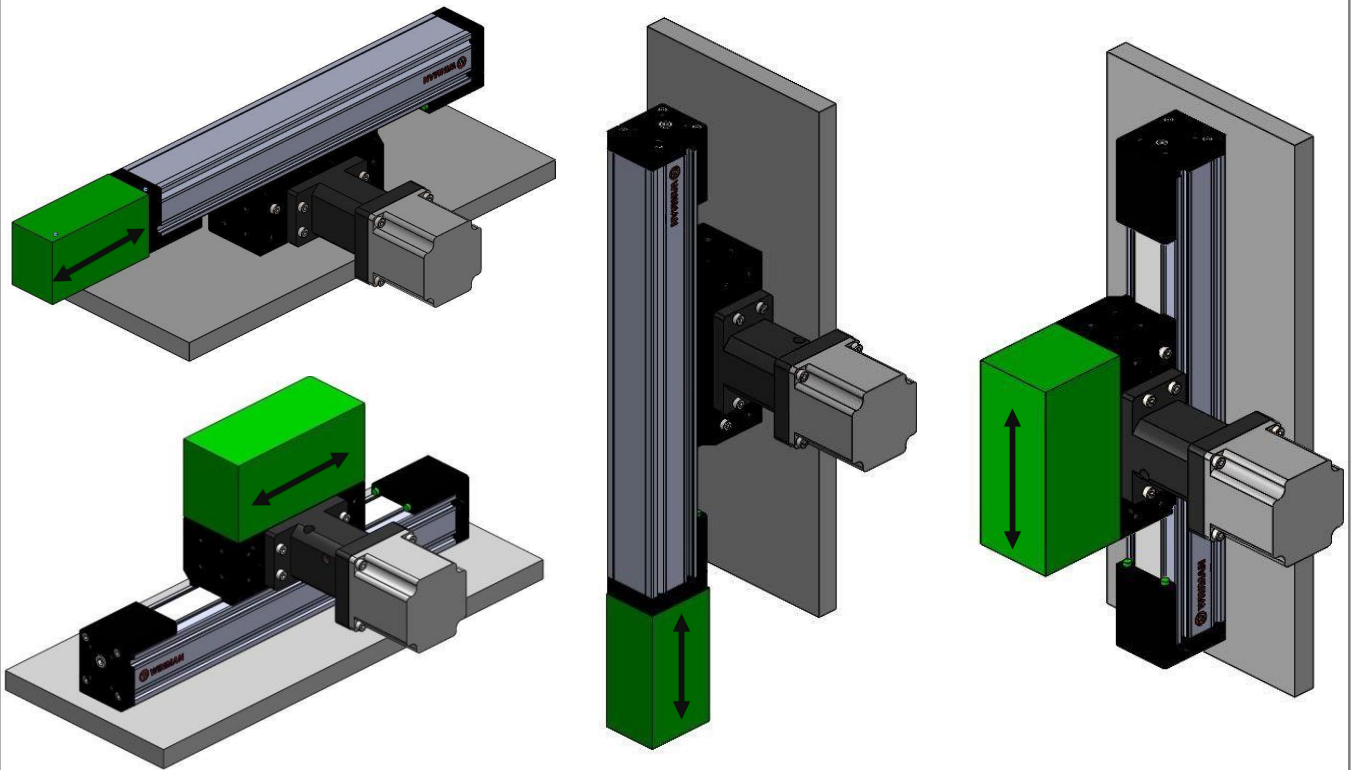
Mounting Orientation Horizontal

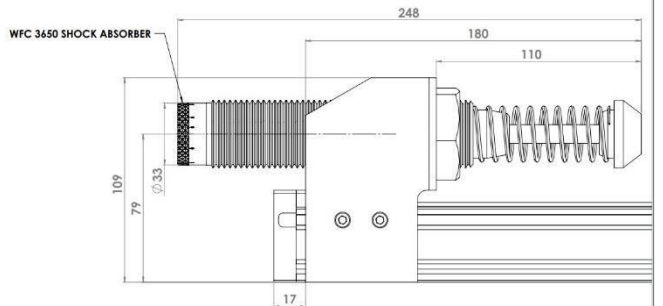
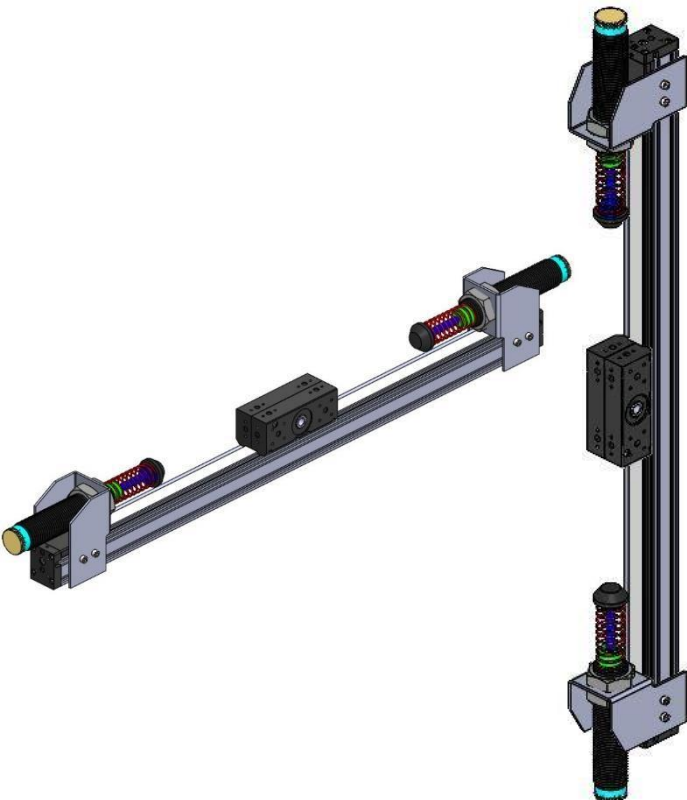

Shock Absorber



Maintenance

Basic lubrication is done in-factory before shipment.

The bearings that support the gear pulleys on the carrier are not necessary relubricating under normal operating conditions.

Omega Modules are designed for grease lubricants only!

Lithium soap grease should be used.

Caution: Do not use grease containing graphite or MoS!

Lubrication is performed every 400 hours or 800 km total working distance by normal operating conditions.

Lubrication quantity is provided in table by normal operating conditions.

After lubrication, move the linear module along the stroke distance at least three times. Meanwhile, the moving speed should not exceed 10 mm/s.

Normal Working Conditions

Note : The lubrication quantity specified in the table is valid for normal operating conditions. The lubrication quantity may vary in different operating conditions. Get information for the lubrication quantity in different working conditions.

Ambient Temperature	°C	10 ~ 40
Speed	m/s	≤ 3,0
Load	kN	≤ 0,2 C
Stroke	mm	> 25
Lubrication Period	km	800
	hour	400
Lubrication Dose	cm ³	0,7

Our company has the right to modify change images, dimensions and other datas which take place in this catalogue.