

**WINMAN 316L Stainless Steel Fittings**

**SSB-G Series**



**Product features**

- The materials ensure Anti-Corrosion highly,all of them are made from SUS316L except the seal ring
- 1450746409402711.jpg FKM is used as the seal ring,which can ensure Anti-Corrosion and acid resistant,also can be used in high temperature
- 1450746409402711.jpg The accessories are oil-free and reach the Food Hygiene Law of People's Republic of China,which are applied widely in the range of industry such as food severice industry, chemical industry and medical industry

**Speciality**

Fluid	Air, Water, Steam
Operating Pressure	0~1.5 MPa
Max Pressure	-1.8 MPa
Operating Temperature	-20 °C~140 °C

**Dimension**

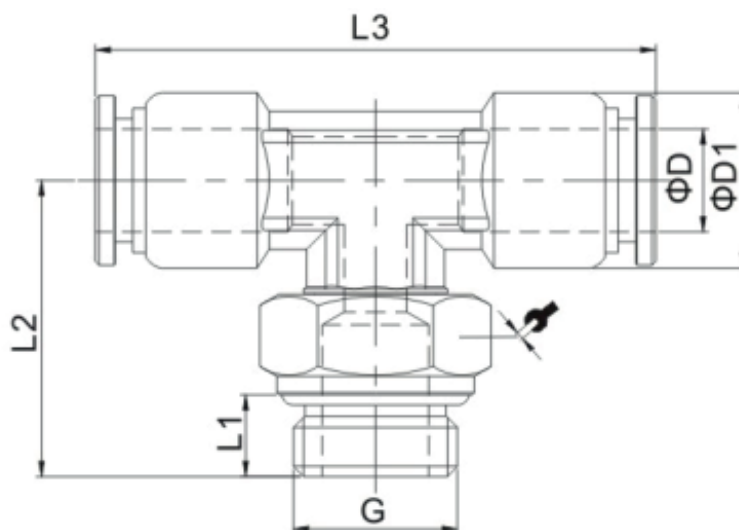

MODEL	φD	G	L1	L2	L3	φD1	🔩
SSB04-M5	4	M5	4	17.5	36.6	10	10
SSB04-G01	4	G1/8	5.5	20	36.6	10	13
SSB06-M5	6	M5	4	17.5	40.6	12	10
SSB06-G01	6	G1/8	5.5	22	40.6	12	13
SSB06-G02	6	G1/4	6.5	23	40.6	12	16
SSB08-G01	8	G1/8	5.5	22.5	44.6	14	13
SSB08-G02	8	G1/4	6.5	23.5	44.6	14	16
SSB10-G02	10	G1/4	6.5	31	52.8	17	17
SSB10-G03	10	G3/8	7.5	28.5	52.8	17	20
SSB10-G04	10	G1/2	9	29	52.8	17	24
SSB12-G02	12	G1/4	6.5	32.5	58.8	20	17
SSB12-G03	12	G3/8	7.5	30	58.8	20	20
SSB12-G04	12	G1/2	9	30.5	58.8	20	24